



MEETING AGENDA



District 1
Matthew Wilson
Chairperson

District 2
Raevan Howard
Vice Chairperson

District 3
Norman Crow
Member

District 4
Lee Busby

District 5
Kip Tyner
Alternate

District 6
John Faile

District 7
Cassius Lanier

Council Properties Committee Meeting Agenda

Tuesday, April 5, 2022 Council Chamber 5:00 p.m.

TOPIC	PRESENTER	SUPPORTING MATERIAL
Approval of Minutes		
NEW BUSINESS		
1. Authorization of commercial marina and dock permit on Lake Tuscaloosa for Bob's Marina	Kevin Turner	2-4
2. Authorization of commercial marina and dock permit on Lake Tuscaloosa for Pier 43 Marina	Kevin Turner	5-9
ADJOURN		

City of Tuscaloosa
Infrastructure & Public Services - Lakes Division

205-349-0279 or lakes@tuscaloosa.com
 City of Tuscaloosa - Lake Division
 3650 Lake Nicol Rd
 Tuscaloosa, Al. 35406



PROPERTY OWNER INFORMATION

Date: 3/1/22

Name: BH2M, LLC dba "Bob's Marina" Tag # 14255 Permit # 476
 Mailing Address: P.O. Box 2086
 City: Tuscaloosa State: AL Zip: 35402

Site Address: 15183 Marina Drive Lot: 5
 City: NORTHPORT State: AL Zip: 35475
 Phone: 205.242.4943 Email: wmoore@pritchett-moore.com

CONTRACTOR / SUB CONTRACTOR INFORMATION

Name: N/A at this time City License # _____
 Mailing Address: _____
 City: _____ State: _____ Zip: _____
 Phone: _____ Email: _____

A COPY OF THE DEED TO THE SUBJECT PROPERTY MUST BE SUBMITTED WITH ALL NEW STRUCTURE PERMITS AND/OR TRANSFERS

PROPOSED DEVELOPMENT BELOW THE ACQUISITION LINE

Describe **IN DETAIL** the proposed development and/or earth change for which you are applying. Write on the back or attach additional sheets if necessary. Please do not reference the plans instead of completing this section.

Land Use:		Permit Type:					
<input type="checkbox"/> New	<input checked="" type="checkbox"/> Transfer	<input checked="" type="checkbox"/> Pier	<input type="checkbox"/> Dredging	<input type="checkbox"/> Boat Hoist	<input type="checkbox"/> Rip Rap	<input type="checkbox"/> Short Term Rental	
<input type="checkbox"/> Addition	<input type="checkbox"/> Repair	<input type="checkbox"/> Boat House	<input type="checkbox"/> Stairs	<input type="checkbox"/> Gazebo	<input type="checkbox"/> Electrical		
<input type="checkbox"/> Pump		<input type="checkbox"/> Retaining Wall	<input type="checkbox"/> Boat Ramp	<input type="checkbox"/> Pump	<input type="checkbox"/> Other		

Sq Ft: _____ Length: _____ Width: _____ Height: _____ Lake Frontage: _____ Total Sq Ft: _____

Office Use Only:

Activity:	Amount:	Received:
Annual User Fee:	\$50	_____
Structure:	\$100	_____
Tag:	\$10	_____
Transfer:	\$50	_____
Dredging:	\$100	_____
Seawall:	\$50	_____
Electrical:	\$50	_____
Clearing:	\$50	_____
Pump:	\$250	_____
Short Term Rental:	\$50	_____

In accepting this permit owner agrees to keep the object of permit neat and in good repair and to obey all the rules and regulations of Lake Tuscaloosa, Set out in ordinance No. 3885.

The City of Tuscaloosa is not responsible for any damage that may occur to the permitted structure, including without limitation damage that arises from falling trees, siltation, defect(s) in or on public property, or any other similar event or cause. Permittee hereby releases and holds harmless the City of Tuscaloosa and its officer's agents and employees for any damage to the permitted structure.

Proposed construction shall meet all applicable codes. I understand that this permit is conditioned upon the correctness of the information I have supplied and may be revoked upon a finding of the Lake Manager, that any relevant item of information is substantially incorrect. this permit becomes null and void if work is suspended or abandoned for a period of 1 year at any time after work has commenced. I hereby certify that I have read and examined this application and know the same to be true and correct. All provisions of laws and ordinances governing this type of work will be complied with whether specifies herein or not, the granting of a permit does not presume to give authority or cancel the provisions of any other state or local law regulating construction or the performance of construction.

Applicants Signature: *Wilson Moore*

Applicants Printed Name: WILSON MOORE, BH2M, LLC

66 x \$25
TOTAL DUE: \$ 1650⁰⁰

Map for Parcel Address: 11423 Stella Way Northport, AL 35475-4577 Parcel ID: 20-05-15-0-007-060.342



PONTON

© 2022 Courthouse Retrieval System, Inc. All Rights Reserved.
Information Deemed Reliable But Not Guaranteed.

★ = 3 floating wet slips

⊗ to be removed.

Google

Bob's Campground & Marina



City of Tuscaloosa
Infrastructure & Public Services - Lakes Division

205-349-0279 or lakes@tuscaloosa.com
 City of Tuscaloosa - Lake Division
 3650 Lake Nicol Rd
 Tuscaloosa, AL 35406



PROPERTY OWNER INFORMATION

Date: 3-14-2022

Name: PIER 43 MARINA Tag # 73074 Permit # _____

Mailing Address: 12175 VIEWPOINT ROAD

City: NORTHPORT State: AL Zip: 35475

Site Address: 12175 VIEWPOINT ROAD Lot: _____

City: NORTHPORT State: AL Zip: 35475

Phone: 205-339-4415 Email: dale@pier43onlaketuscaloosa.com

CONTRACTOR / SUB CONTRACTOR INFORMATION

Name: PIER 43 MARINA City License # 121607

Mailing Address: SAME AS ABOVE

City: _____ State: _____ Zip: _____

Phone: _____ Email: _____

A COPY OF THE DEED TO THE SUBJECT PROPERTY MUST BE SUBMITTED WITH ALL NEW STRUCTURE PERMITS AND/OR TRANSFERS

PROPOSED DEVELOPMENT BELOW THE ACQUISITION LINE

Describe **IN DETAIL** the proposed development and/or earth change for which you are applying. Write on the back or attach additional sheets if necessary. Please do not reference the plans instead of completing this section.

NEW BOAT WET SLIPS TO BE CONSTRUCTED BY OWNER. NO ELECTRICAL ATTACHED.

Land Use:

- New
- Addition
- Pump
- Transfer
- Repair

Permit Type:

- Pier
- Boat House
- Retaining Wall
- Dredging
- Stairs
- Boat Ramp
- Boat Hoist
- Gazebo
- Pump
- Rip Rap
- Electrical
- Other
- Short Term Rental

Sq Ft: _____ Length: 400' Width: 30' Height: 10' Lake Frontage: 400 Total Sq Ft: 12,000

Office Use Only:

Activity:	Amount:	Received:
Annual User Fee:	\$50	
Structure:	\$100	<u>\$3075.00</u>
Tag:	\$10	_____
Transfer:	\$50	_____
Dredging:	\$100	_____
Seawall:	\$50	_____
Electrical:	\$50	_____
Clearing:	\$50	_____
Pump:	\$250	_____
Short Term Rental:	\$50	_____

TOTAL DUE: \$3075.00

In accepting this permit owner agrees to keep the object of permit neat and in good repair and to obey all the rules and regulations of Lake Tuscaloosa, Set out in ordinance No. 3885.

The City of Tuscaloosa is not responsible for any damage that may occur to the permitted structure, including without limitation damage that arises from falling trees, siltation, defect(s) in or on public property, or any other similar event or cause. Permittee hereby releases and holds harmless the City of Tuscaloosa and its officer's agents and employees for any damage to the permitted structure.

Proposed construction shall meet all applicable codes. I understand that this permit is conditioned upon the correctness of the information I have supplied and may be revoked upon a finding of the Lake Manager, that any relevant item of information is substantially incorrect. this permit becomes null and void if work is suspended or abandoned for a period of 1 year at any time after work has commenced. I hereby certify that I have read and examined this application and know the same to be true and correct. All provisions of laws and ordinances governing this type of work will be complied with whether specifies herein or not, the granting of a permit does not presume to give authority or cancel the provisions of any other state or local law regulating construction or the performance of construction.

Applicants Signature: Dale P. [Signature]

Applicants Printed Name: Dale P. [Signature] Gm



Parcel: 1509320020003003
Name: KKS PROPERTIES LLC
Address: 12420 HIDE AWAY LN
Address2:
STR 32-19S-10W

PIER 43
NEW CONSTRUCTION
COVERED BOAT SLIPS

ROOF / WALL SUPPORTS SIDE VIEW

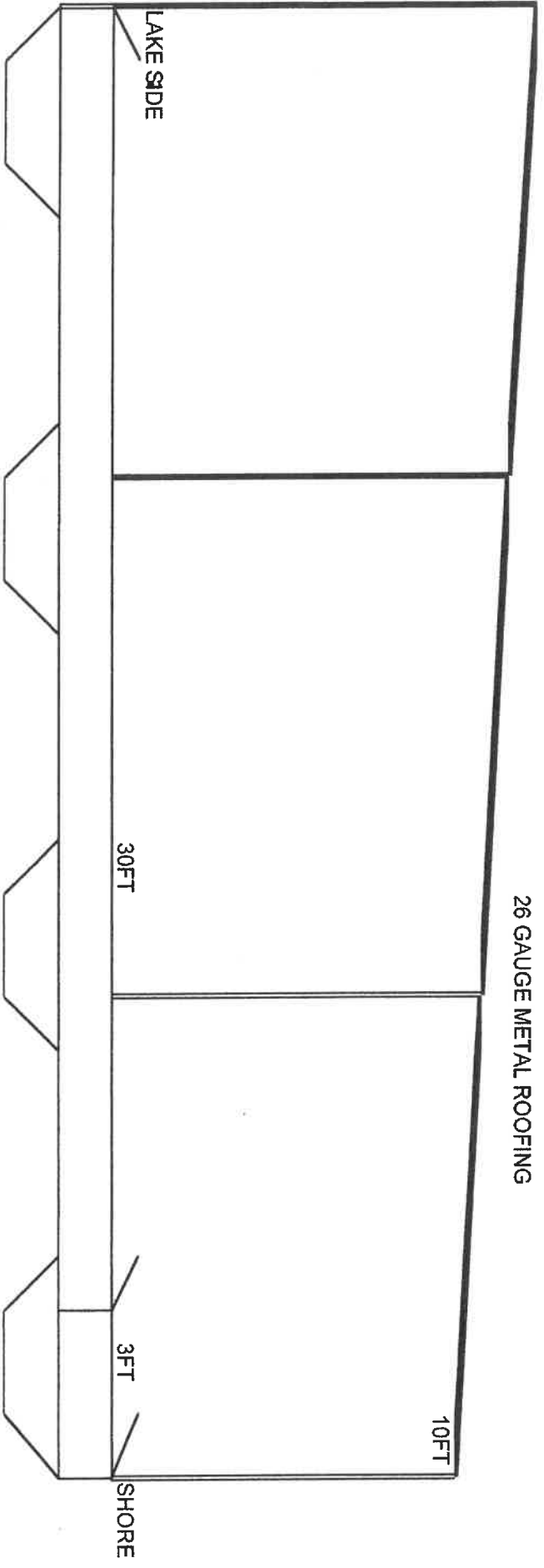

NOT TO SCALE

30 NEW BOAT SLIPS

PIER 43
CONSTRUCTION PLAN
MASTER DIAGRAM

LAND

LAKE

30 FT

3 FT WALK 10 FT

30 BOAT SLIPS TO REPLACE OLD EXISTING SLIPS

No Power Installed
No Water Installed

PIER 43 CONSTRUCTION PLAN MASTER DIAGRAM

